

SL 103

Now available with the

SHY Zip Track System

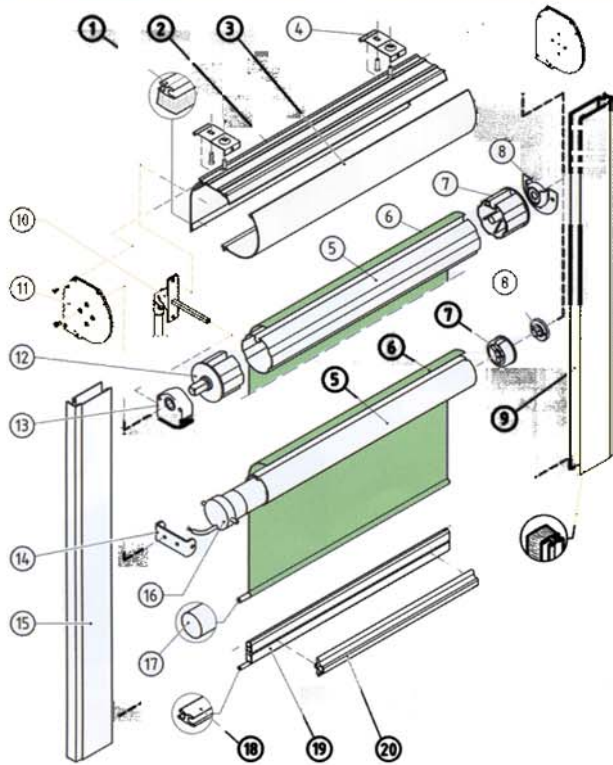

- | | |
|--------------------------------|---------------------------------------|
| 1 Brush strip | 11 Hood end cap |
| 2 Hood fixed side | 12 Square pin end cap |
| 3 Hood removable side | 13 Gear assembly |
| 4 Ceiling bracket | 14 Motor bracket |
| 5 Roller tube | 15 Side Track (G80) |
| 6 PVC weld strip | 16 Tubular Motor |
| 7 Idler end cap | 17 PVC tubing |
| 8 Idler bracket | 18 Brush strip |
| 9 Side track (G80) | 19 Bottom rail (FG42) |
| 10 Through wall crank assembly | 20 Reinforcement for FG42 bottom rail |

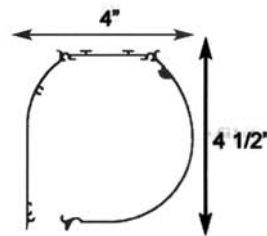

System Standard Colors Are White & Bronze.

Other colors available upon request with surcharge.

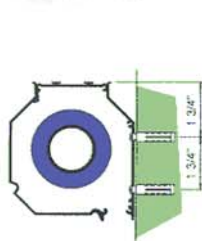

Wall mount through back of box

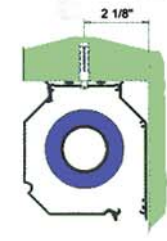

Ceiling mount through top of box

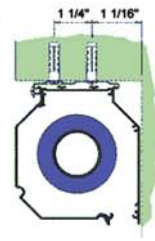

Ceiling mount using ceiling bracket

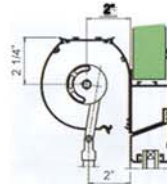

Standard crank operation

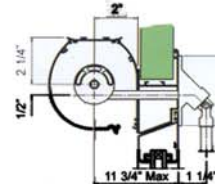

Through wall crank operation • small gear

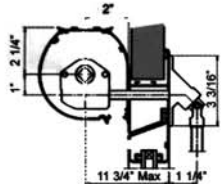

Through wall crank operation • large gear

